

FORK SPRING INSTALLATION INSTRUCTIONS

Remove fork legs from motorcycle. Loosen and remove top fork caps. Pull spring out and replace with new BBR springs. Check oil levels and add oil as necessary. Note: Oil level is checked with fork collapsed and no spring. Repeat for second fork leg and reverse process to reinstall.

Standard Fork Oil Levels*

CRF/XR70:	135mm
CRF/XR100:	205mm
CRF150F:	136mm
CRF230F:	140mm
TTR90:	60mm
TTR110:	92mm
DRZ/KLX110:	89mm
DRZ/KLX125:	172mm
KLX140L:	105mm

*Measured from the top of the chrome tube with the spring out and fork collapsed

BBR Motorsports recommends starting with the standard oil viscosity and height. Heavy riders may want to switch to a heavier fork oil or raise the oil level. Check your owners manual for proper service information and fork oil level measurement. Too much oil can result in hydraulic lock and/or blown fork seals.

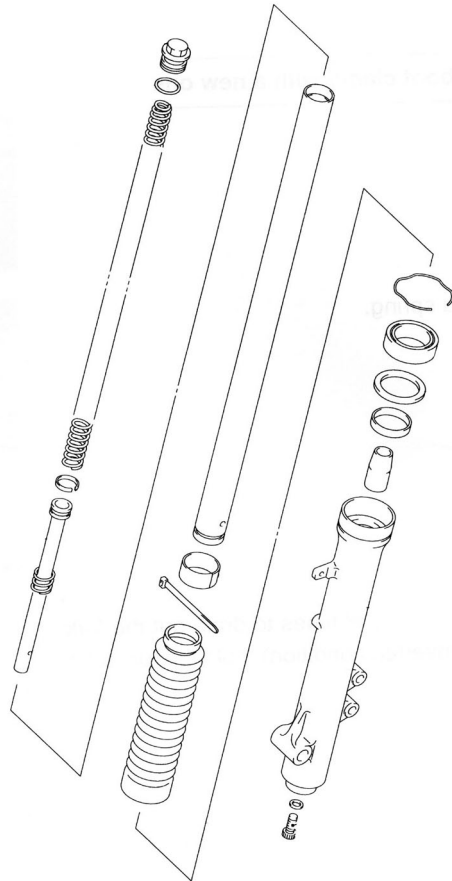

TYPICAL FORK ASSEMBLY

BBR
M O T O R S P O R T S

(253) 631-8233
www.bbrmotorsports.com

FORK SPRING INSTALLATION INSTRUCTIONS

Remove fork legs from motorcycle. Loosen and remove top fork caps. Pull spring out and replace with new BBR springs. Check oil levels and add oil as necessary. Note: Oil level is checked with fork collapsed and no spring. Repeat for second fork leg and reverse process to reinstall.

Standard Fork Oil Levels*

CRF/XR70:	135mm
CRF/XR100:	205mm
CRF150F:	136mm
CRF230F:	140mm
TTR90:	60mm
TTR110:	92mm
DRZ/KLX110:	89mm
DRZ/KLX125:	172mm
KLX140L:	105mm

*Measured from the top of the chrome tube with the spring out and fork collapsed

BBR Motorsports recommends starting with the standard oil viscosity and height. Heavy riders may want to switch to a heavier fork oil or raise the oil level. Check your owners manual for proper service information and fork oil level measurement. Too much oil can result in hydraulic lock and/or blown fork seals.

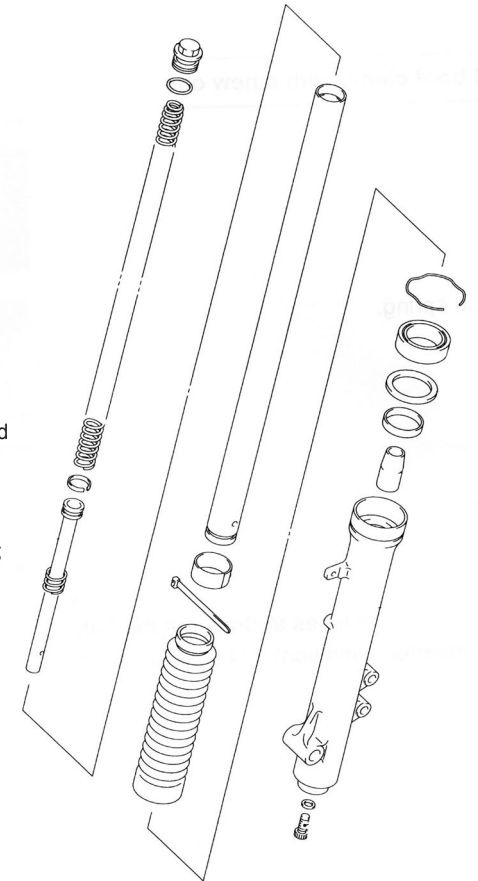

TYPICAL FORK ASSEMBLY

BBR
M O T O R S P O R T S

(253) 631-8233
www.bbrmotorsports.com